

MOON ORGANIZER

Assemble manual

Hello! Thank you for choosing our products. We put our hearts into making them, so we're even more delighted that you liked them. In the following instructions, you will find all the information you need.

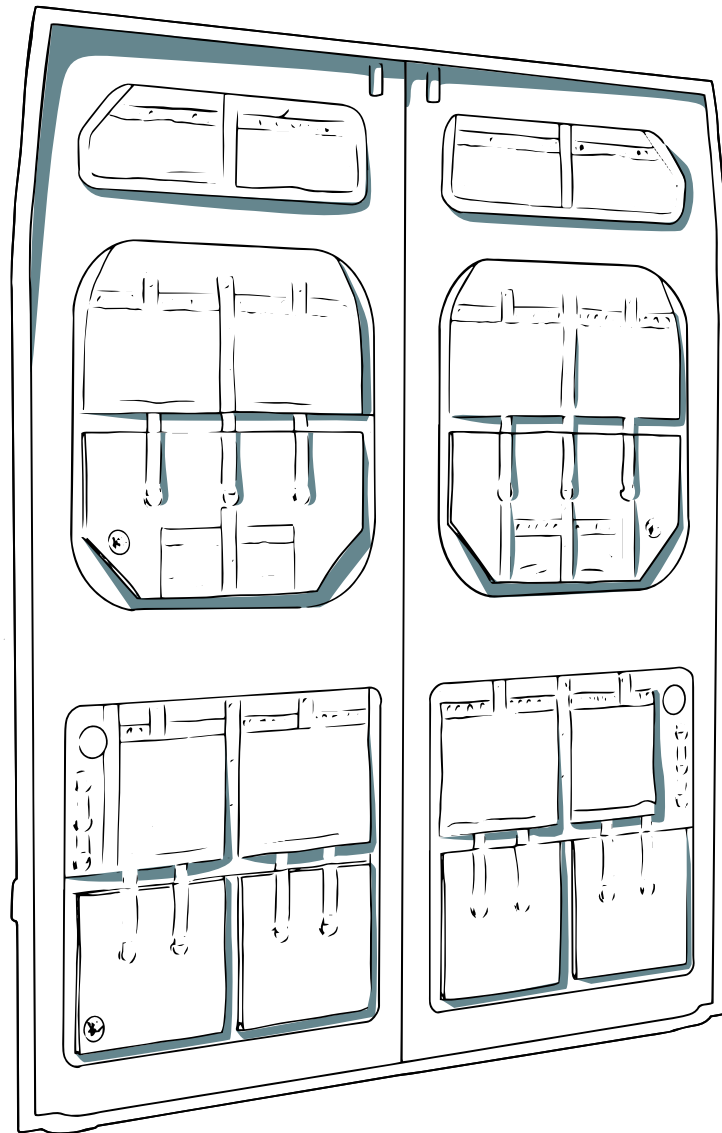

Live light at
vandermoon.com





Since 1993, Vitberg has been producing medical devices for rehabilitation, treatment, cosmetology and sports.

Its products are known and appreciated.

Medicine and technology are not our only passion, we also love exploring the world.

We have translated the experience gained over the years into the production of accessories for people like us.

This is how the Van Der Moon brand was born.

Made in Poland, EU.
www.vandermoon.com

Contents

General informations	4
Available versions	5
Tools needed	6
Mounting hardware	6
Prepare the car for installation	7
I. Assembly in the upper and lower recess	8
II. Window recess installation	10
III. Assembly of the Organizer MAX	13

General **information**

Designed for heavy-duty use.

The incredibly durable and surprisingly lightweight Moon Organizer is constructed from 4mm thick hardwood plywood. The front side of the plywood is covered with a 5mm foam layer, onto which a durable technical fabric cover is applied. This material is characterized by its strength and high resistance to abrasion, tearing, and mechanical stress. It is lightweight and relatively rigid, crafted from polyester fibers that absorb moisture lightly. However, thanks to the PVC-coated bottom layer, the fabric is waterproof. The applied soundproofing ensures that the items stored in the pockets do not vibrate during travel. The back of the Moon Organizer is lined with felt-like material, effectively dampening the space between the plywood of the organizer and the vehicle's body.

The Moon Organizer is designed to maximize space in your van. When mounted on the rear doors, it provides access to handy tools. The abundance of pockets, nets, hooks, and straps ensures that everything is always within reach (and in its proper place). A set of organizers allows you to transport over 60 liters of luggage without sacrificing interior space in the vehicle.

Available colours:



Anthracite



Gray



Blue



Red



Green

Compatible car models, Moon Organizer:

Mercedes Sprinter 906
Mercedes Sprinter 907
Volkswagen Crafter II > 2016, H2, H3
Volkswagen LT < 2006
Man TGE > 2017, H2, H3
RAM ProMaster > 2013
Fiat Ducato version III > 2006
Citroen Jumper version II > 2006
Peugeot Boxer version II > 2006
Renault Master III
Nissan Interstar
Nissan Interstar II NV400
Opel Movano B (2)
Opel Movano 3

Compatible car models, Moon Organizer MAX:

Mercedes Sprinter 906
Mercedes Sprinter 907
Volkswagen Crafter II > 2016, H2, H3
Man TGE > 2017, H2, H3

Available **versions**

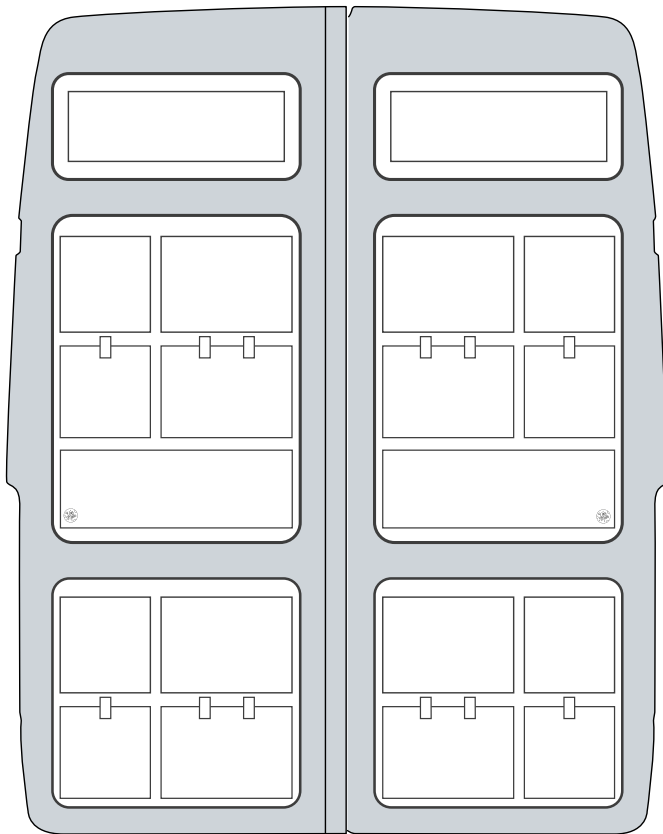

Illustrative drawing

MOON**ORGANIZER**

Depending on the make and model of your vehicle, you can install anywhere from 1 to even 6 Moon Organizers. We have precisely tailored the components to fit perfectly into the recesses found in the rear doors of your van. The products vary in shape, arrangement of elements, and pockets depending on the vehicle.

We approach each shape individually to maximize storage space utilization.

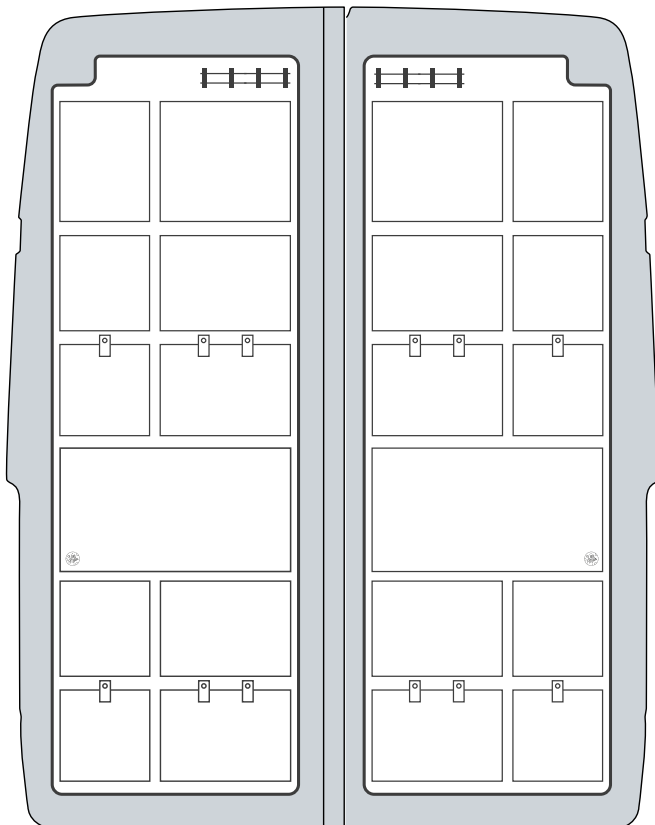

Illustrative drawing

MOON**ORGANIZER** MAX

The Moon Organizer MAX will cover the entire door. You can choose the right, left, or both door wings. For transportation, production, and ease of installation reasons, we have divided it into two segments that fit together perfectly.

This solution increases the capacity and covers the entire door of the vehicle.

We have filled the available spaces with eyelets and clips so you can attach even the smallest items to it.

Tools **needed**



Pencil



Soldering iron



Drill



Screwdriver

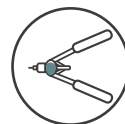

Riveting machines
for rivet nuts

Set of **elements we**



Mounting bracket
or angle bracket.

The kit includes **only** mounting brackets for the Moon Organizers that fit into the central recess of the rear doors of the vehicle. The upper and lower recesses, as well as the Moon Organizer MAX, do not require the use of mounting brackets for installation.



Rivet nut M5



Bolt M5 with crew washer ø5

lub

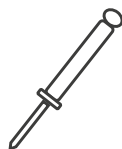

Blind rivet

lub*



Screw ø5 *

Important!

You can replace M5 rivet nuts, M5 screws, and ø 5 washers with sheet metal screws or wood screws. In the case of mounting with sheet metal screws or wood screws, **the manufacturer is not responsible** for the load-bearing capacity of these connections and does not recommend such installation. You will achieve maximum benefits from using the Moon Organizer **ONLY** when you attach the product with M5 rivet nuts, M5 screws, and ø 5 washers or removable rivets.

Prepare your car for assembly

MOON**ORGANIZER**

The method of mounting the Moon Organizer depends on the location where it will be assembled:

- I. Mount the Moon Organizer in the upper and lower recesses directly to the vehicle's body – **page 8**
- II. Mount the Moon Organizer in the window recess using mounting brackets – **page 10**
- III. Mount the Moon Organizer MAX directly to the vehicle's body – **page 13**

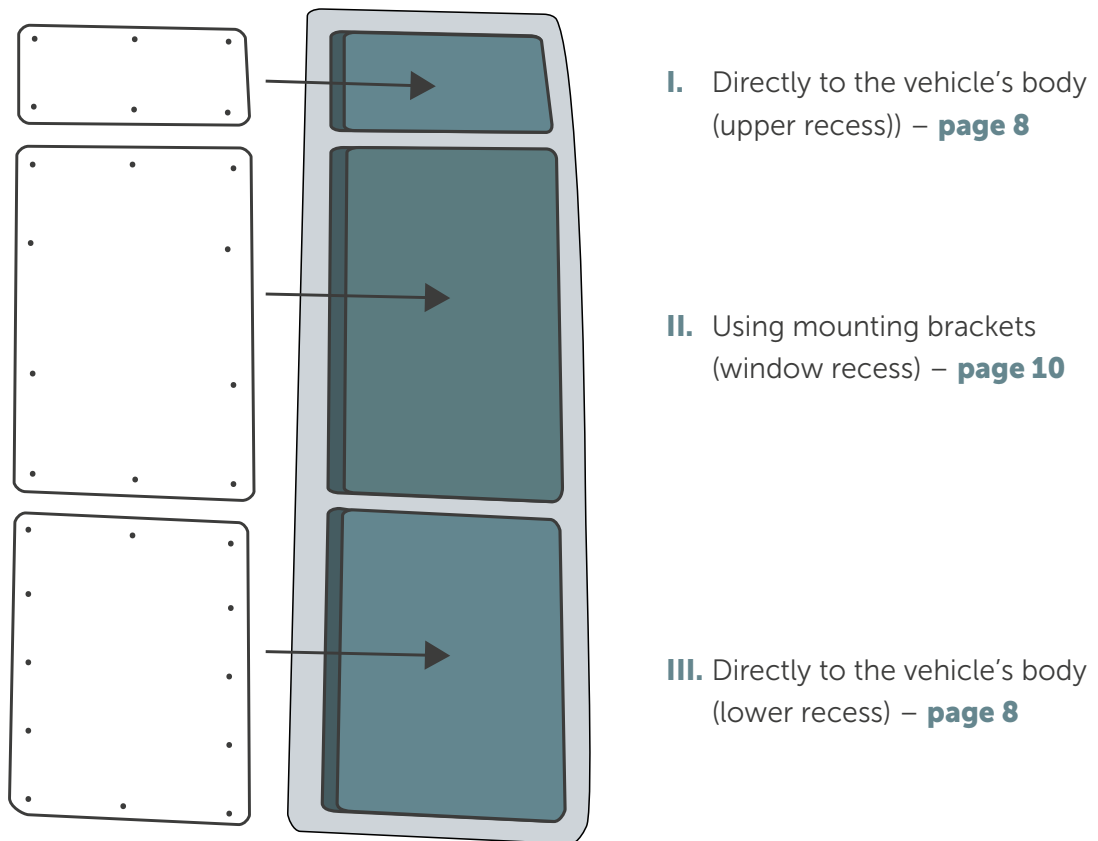

Watch a Moon Organizer installation video.

I. Assembly in the **upper and lower** recesses.



Soldering iron



Pencil

Step 1

Jeśli nie masz własnej koncepcji montażu, zlokalizuj zaznaczone punkty mocowania na odwrocie Moon Organizera. W zaznaczonych miejscach wykonaj otwory na wylot wykorzystując rozgrzany grot lutownicy.

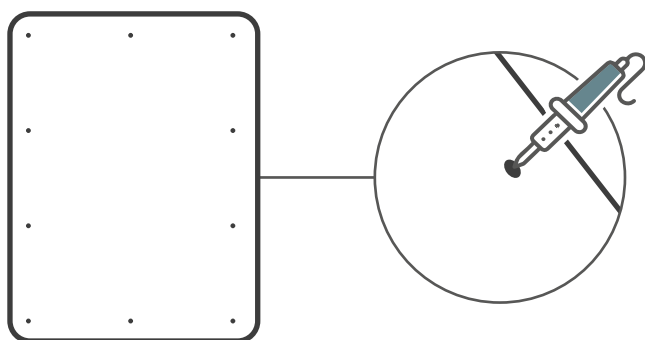

Step 2

Przyłóż Moon Organizer do korespondującej wnęki w drzwiach samochodu. Przez otwory znajdujące się po obwodzie Moon Organizera, zaznacz punkty wiercenia.

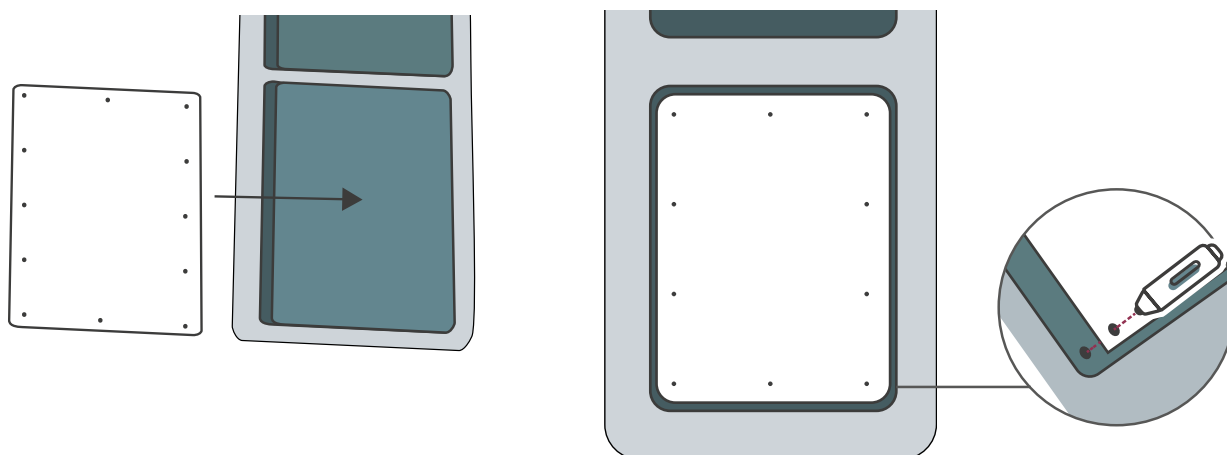

Step 3



Drill

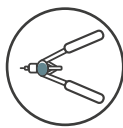

Riveting machines for rivet nuts



Rivet nut M6

W zaznaczonych wcześniej miejscach wywierć otwory w drzwiach samochodu. W wywierconych otworach zaciśnij nitonakrętki.

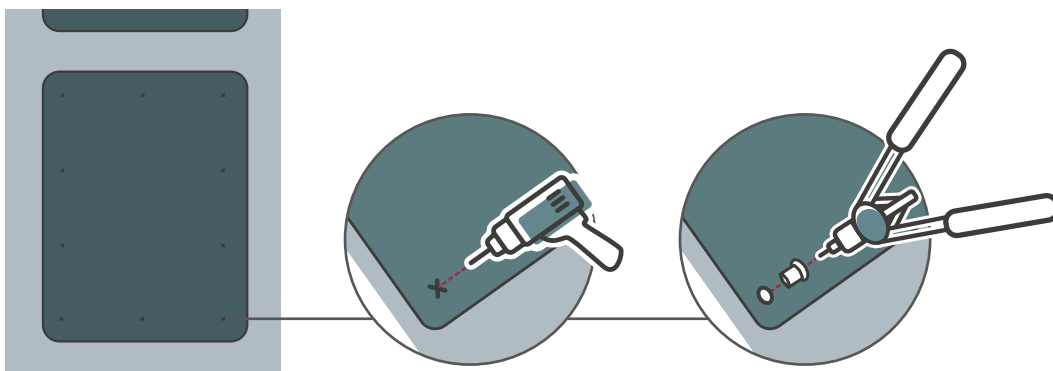

Step 4



Screwdriver



Śruba M5 i podkładka $\varnothing 5$

Przymocuj Moon Organizer za pomocą śrub i podkładek. Gotowe!

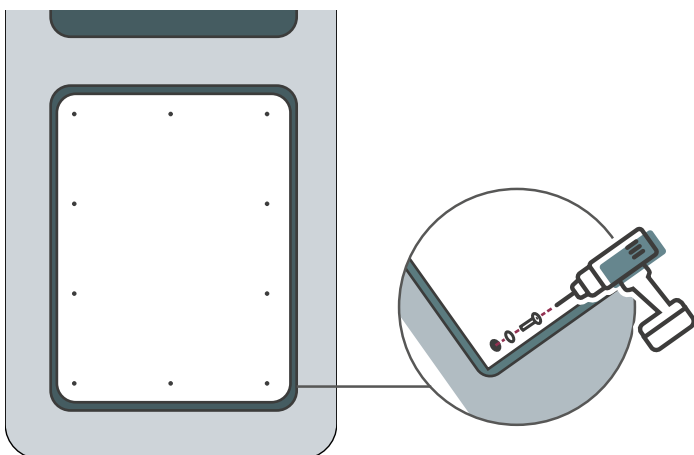

II. Assembly in the **window recess**.

Step 1



Soldering iron



Pencil

If you don't have your own mounting concept, locate the marked attachment points on the back of the Moon Organizer. In the designated locations, create holes using a heated soldering iron tip.

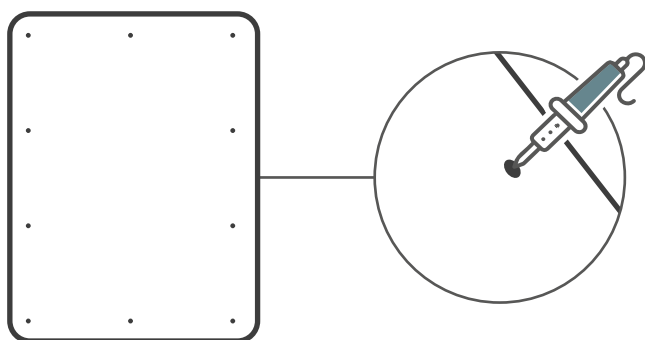

Step 2

Place the Moon Organizer in the window recess of the car door. At the mounting hole locations, use a pencil to mark the positions for the mounting brackets. Do this on the vehicle's body, next to the Moon Organizer, as shown in the image below.

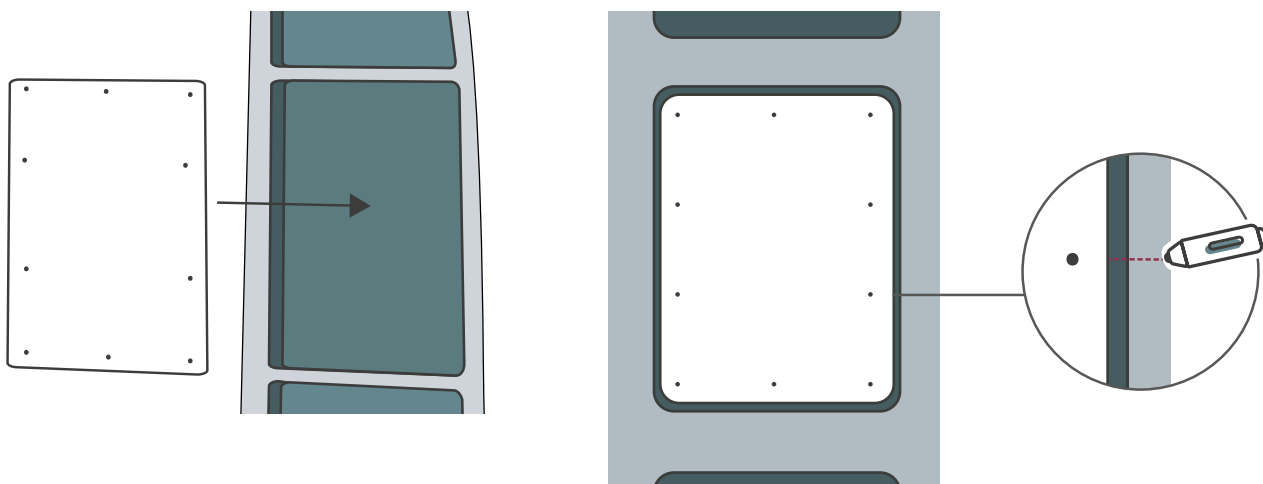

Step 3



Pencil



Drill



Kątownik montażowy

Place the mounting bracket or angle bracket in the center of the previously marked points. In the holes of the mounting bracket, mark the drilling points. Then, drill the holes.

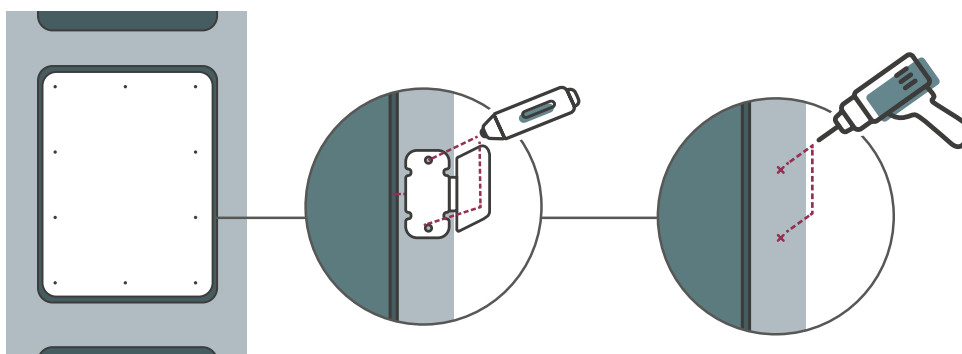

Step 4

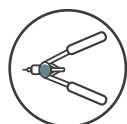

Riveting machines for rivet nuts



Screwdriver



Rivet nut M6



Śruba M5 z podkładką ø5

Tighten the rivet nuts into the holes, then attach the mounting brackets using screws and washers. You can also secure the mounting brackets with removable rivets.

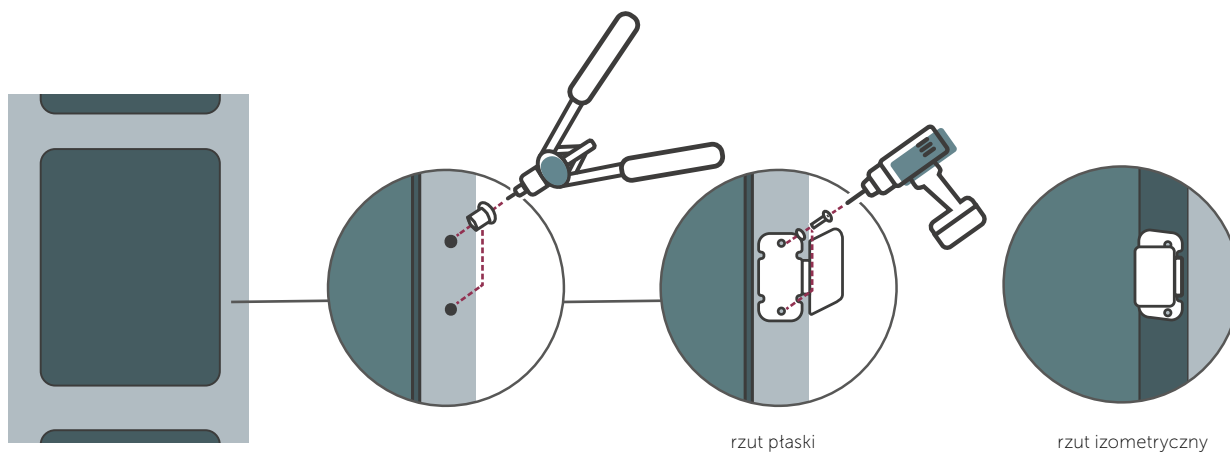

Step 4



Pencil



Drill

Place the Moon Organizer in the window recess of the car door. Through the holes located around the perimeter of the Moon Organizer, mark the drilling points on the mounting brackets. Then, drill the holes.

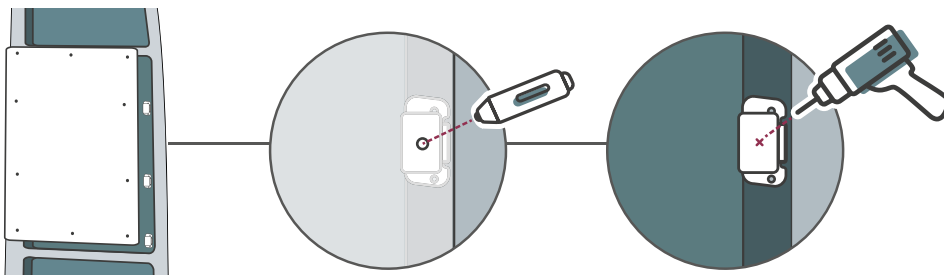

Step 5



Screwdriver

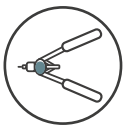

Riveting machines for rivet nuts



Śruba M5
z podkładką ø5

Tighten the rivet nuts in the mounting brackets. Then, attach the Moon Organizer using screws and washers. You're done!

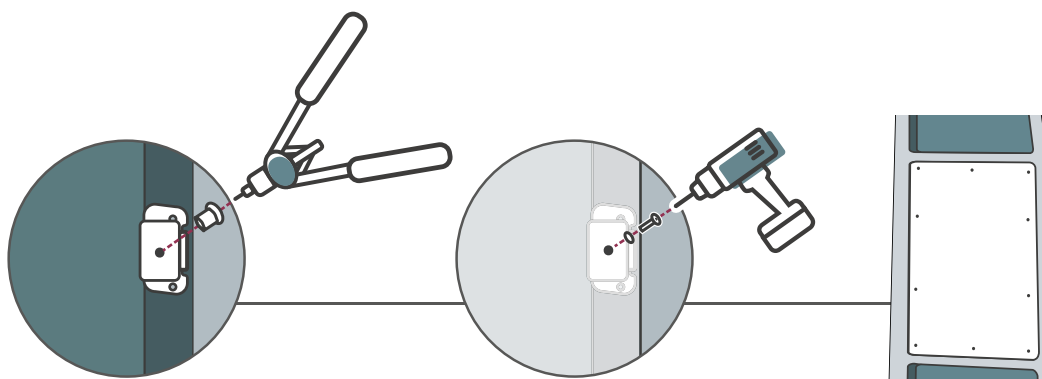

I. Montaż MOON**ORGANIZER** MAX



Soldering iron



Pencil

Step 1

If you don't have your own mounting concept, locate the marked attachment points on the back of the Moon Organizer Max. In the designated locations, create holes using a heated soldering iron tip.

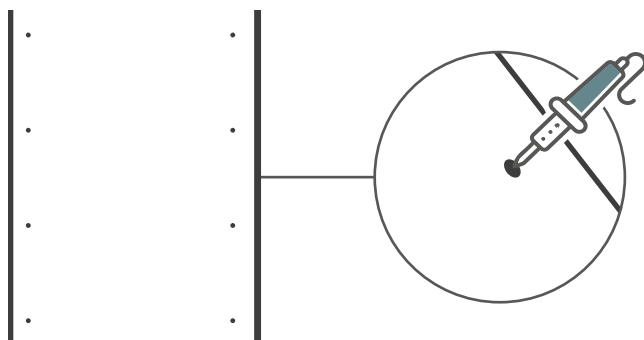

Step 2

Place the Moon Organizer Max in the corresponding recess in the car door. Through the holes located around the perimeter of the Moon Organizer Max, mark the drilling points on the vehicle's body. Start from the lower part of the Moon Organizer Max.

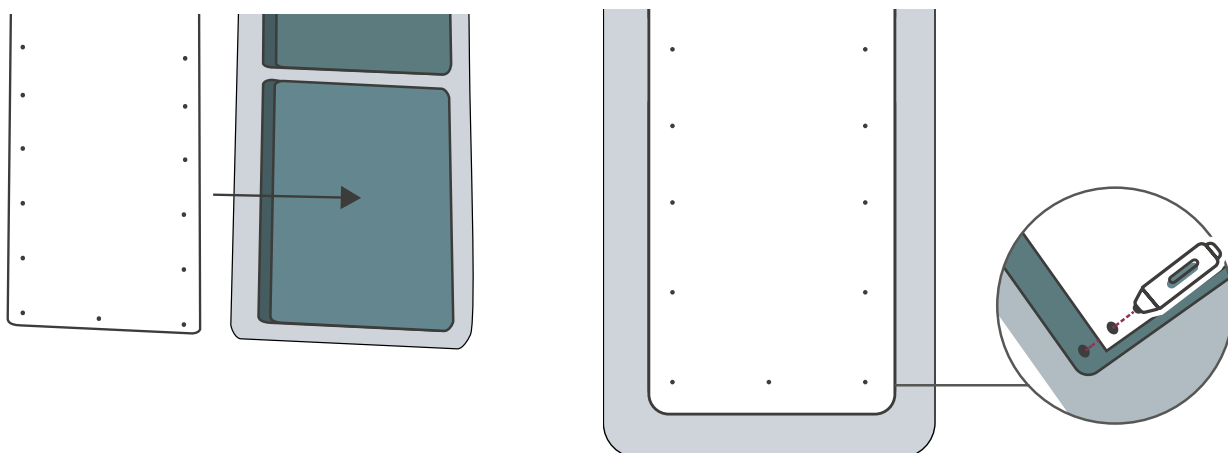

Step 3

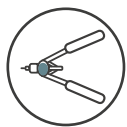

Riveting machines for rivet nuts



Screwdriver



Rivet nut M6

In the previously marked locations, drill holes in the car door. Tighten the rivet nuts in the drilled holes.

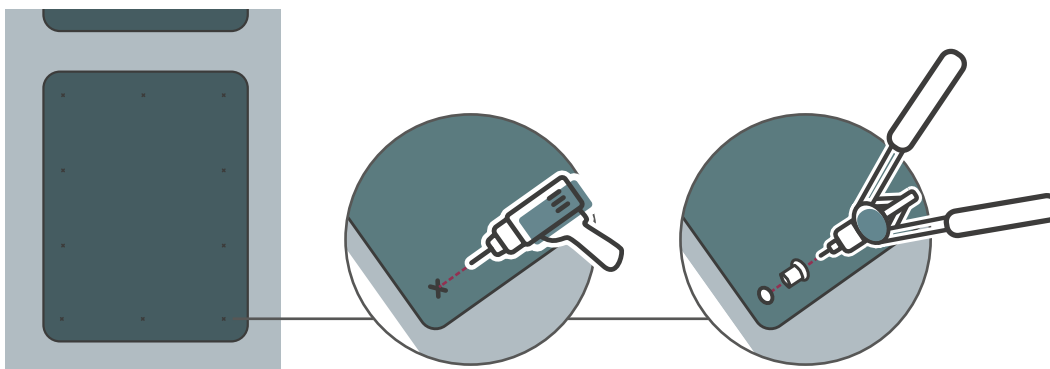

Step 4



Screwdriver



Śruba M5
z podkładką ø5

Attach the Moon Organizer Max using screws and washers. You're done!

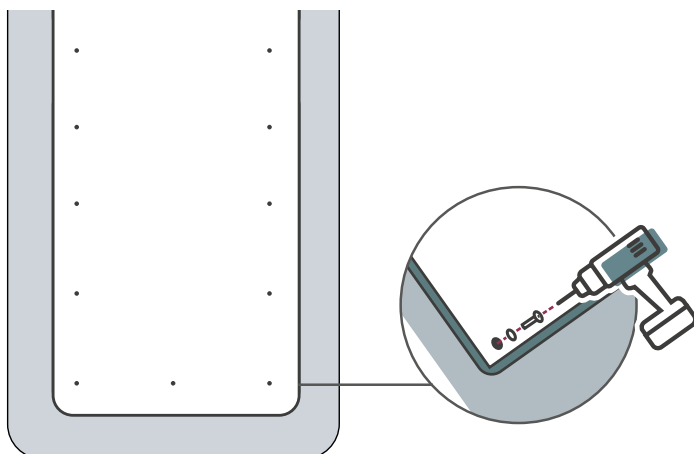

Informacje **dotyczące użytkowania**



Czyszczenie

Handwash. Rinse the soiled area thoroughly with clean water and wipe it with a sponge gently using a mild detergent.

Do not use bleach, iron or heat drying. The product is not machine washable. Before cleaning, remove all elements from the inside of the Moon Organizer along with the shelf.

Metal parts should be dry cleaned.

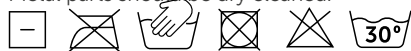

Skład

poliester 100%, coating PVC-FLAT,
aluminium, polypropylene plate



Transport i przechowywanie

The products are packed in cardboard outer packaging.

During transport, they should be placed horizontally or vertically.

Must be transported in the original packaging.



Utylizacja opakowania

The packaging is made of recyclable cardboard, so it should not be thrown away, but stored in a landfill in waste paper bins or special containers for cardboard packaging.



Środki ostrożności

Please make sure you have read and understood the instructions before using the Moon Organizer.

After installation, it is recommended to check the mounting of the Moon Organizer by pulling the entire structure firmly.

Do not leave the Moon Organizer in direct sunlight - it may cause fading of the material. This does not change the mechanical properties of the material.

Do not use open fire near the Moon Organizer.

Protect against moisture.

Do not load the Moon Organizer beyond the recommended maximum weight.

Do not use any sharp objects such as knives, screwdrivers, etc. to remove the outer packaging.



www.vandermoon.com



Contact

tel. +48 18 442 33 69
shop@vandermoon.com

Van der Moon® is a registered trademark of the Vitberg Sikora Jacek. ©
Vitberg Sikora Jacek – all rights reserved.
Made in Poland.
